

Kit # 8045 2008-2010 Challenger T/A System

Notice: Pre fit before painting! Install new, unpainted parts according to these instructions! Then remove parts, paint them and re-install! Painted or Altered Parts are Non-Refundable! After the parts have been primed and painted install the double sided tape! The surface where the 3M double sided tape is contacting must be cleaned with isopropyl alcohol and be a minimum of 75 degrees F constant through out the drying process! Allow the 2-sided tape to dry 24 hours before driving!

Step 1: Loosen the hose clamp around the air intake duct and pull it off the air box. Pull the vent hose off and remove the bolt securing the air box to the car **as shown in fig.A**. Remove the factory air box. **(Keep the hardware as it will be reused.)**

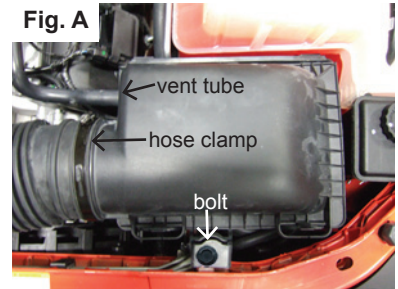

Step 2: Remove the rubber grommet from the factory air box and install it on the cervini air box **as shown in fig.B**.

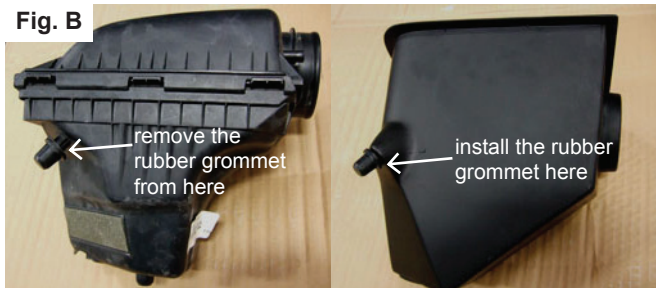

Step 3: Install the cervini's air box to the car in the stock location with the stock hardware. Push the K&N air filter into the air intake opening. The filter is a tight fit design and does not need to be clamped. Use the small allen screws to install the billet aluminum air vent **as shown in fig.C**. Reinstall the intake duct to the cervini air box with the stock clamp.

Step 4: Remove the vent hose from the car completely and install the supplied air breather to the intake manifold where the vent tube used to be **as shown in fig.D**. (You may need to use a little bit of lubricant to help slide the air breather on.)

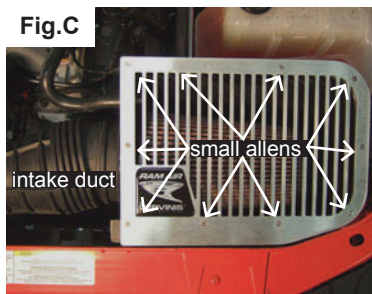

| KIT# 8045 | | |
|-----------|------------------------|------------|
| QTY | DESCRIPTION | HARDWARE # |
| 10 | SMALL HEX SCREWS | 92210A145 |
| 9 | SHORT PHILLIPS SCREWS | 3265 |
| 11 | 3/4" PHILLIPS SCREWS | 32144 |
| 9 | 1" PHILLIPS SCREWS | 2623 |
| 22 | SELF TAPING PHILLIPS | 92364A148 |
| 1 | 6X17 PERFORATED SCREEN | KAN-014 |
| 1 | ROLL OF 2-SIDED TAPE | VHB 115 |
| 1 | 45" RUBBER SEAL | X135BT |



| KIT# 8045 | | |
|-----------|----------------|------------|
| QTY | DESCRIPTION | HARDWARE # |
| 1 | AIR BOX | 4382 |
| 1 | T/A SCOOP | 4386A |
| 1 | AIR DUCT | 4386B |
| 1 | AIR DIVIDER | 4386C |
| 1 | RAM AIR SCREEN | 060 |
| 1 | AIR FILTER | 0810 |
| 1 | AIR FILTER 04 | 3992 |

Step 5: Use the supplied screen template to cut out two screens from the provided perforated screen. Install the screen to the openings in the air divider with three of the short Phillips screws **as shown in fig.E**. After the screen is installed and the scoop painted, slide the air divider into the hood scoop. Align the pre-drilled holes in the air divider to the pre-dilled holes in the hood scoop. Install three of the 3/4" long screws in the front of the air divider first. **(This will pull the part tight to the front of the hood scoop.)** Install six of the 3/4" long screws into the sides of the air divider. Then, use four of short Phillips screws in the back of the air divider to secure the two pieces together **as shown in fig.F**. Included in the hardware packet is a roll of 3M double sided tape. After the hood scoop has been painted, install the 3m double sided tape along the guidelines an 1/8" away from the outer edge of the part **as shown in fig.F**. **(Notch the double sided tape out around the screw holes.)**

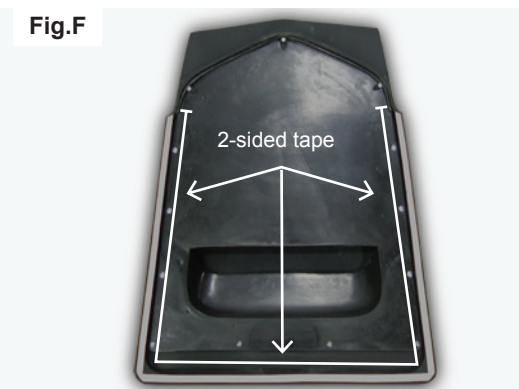
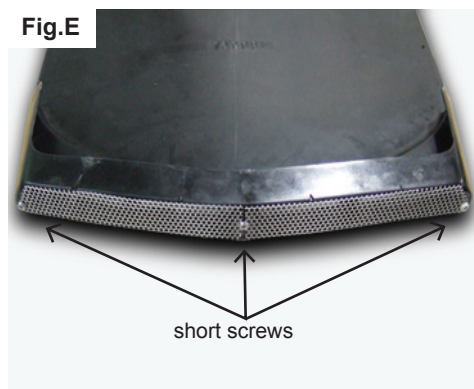

Step 6: Use a 3/16" drill bit to drill out the marked locations on the hood for the hood scoop. Peel and fold about 2" of the red backing from each end of each piece of tape so that the red backing is exposed and can be pulled **as shown in fig.G**. Place the hood scoop on the hood. Use nine of the 1" long black screws on the front and sides of the scoop and two of the 3/4" screws in the back of the scoop where the squirter go **as shown in fig.H**. **(Do not tighten the screws!)** Slowly peel the red backing from the tape. Firmly press the back of the scoop to the hood securely adhering the tape. Working towards the front, firmly press the sides of the hood scoop to the hood securely adhering the tape. Tighten the screws at this time.

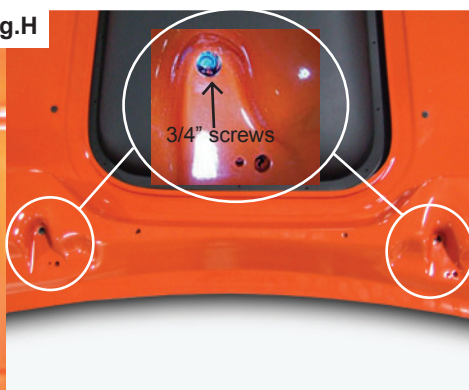
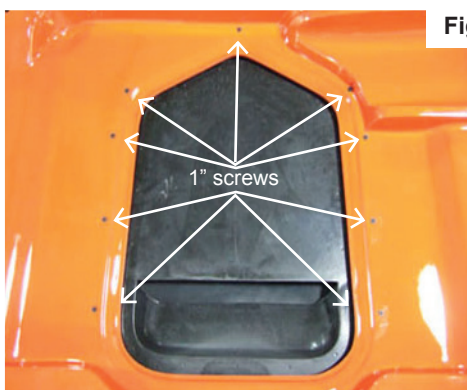
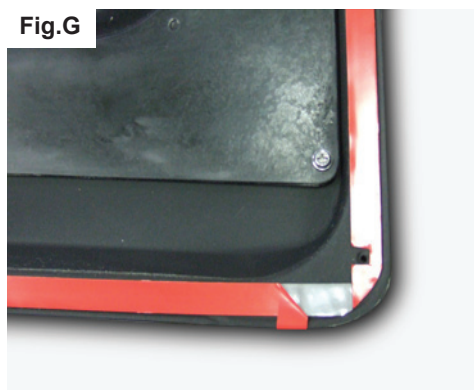

Step 7: Place the duct on the bottom of the air divider and install the supplied self tapping phillips screws to the front of the hood through the pre-drilled holes in the duct **as shown in fig.I**. Then, install the remaining self tapping phillips screws into the air divider through the pre-drilled holes in the duct to the **as shown in fig.J**.





STEP 8: Install the rubber seal to the underside of the hood as shown in fig.K.

URETHANE PAINTING INSTRUCTIONS

VERY IMPORTANT: The following painting procedures **MUST** be followed **EXACTLY** for **PROPER ADHESION** and to prevent fish eyes.

1. To remove any mold release contaminants, clean the back of the part first. Using 2 new clean rags, saturate the first rag with plastic prep cleaner* and begin cleaning. Then use the second rag to remove the prep cleaner. Continuously fold both rags to their clean sides during the process. Use 3 sets of new rags throughout the process. This prevents mold release contaminants from transferring to the painted surface.
2. Repeat step one on the front of the part.
3. Rinse the part with water. Apply a generous amount of Ajax® or sand fix* to a red scuff pad* (3M Scotch Brite Brand) and scrub the surface to be painted **THOROUGHLY** (especially where the 2-sided tape is installed, on the back side of the part, and all the hard to reach areas). Then rinse with water and dry. The scrubbed surface should be dull. If any shiny spots show, repeat the process on those areas.
4. Using another set of clean new rags, again clean the surface to be painted with plastic prep cleaner.
5. Spray the surface to be painted with adhesion promoter* including the areas where the 2-sided tape is installed (follow the instructions on the can for application and drying time).
6. Apply 3 to 4 coats of urethane primer* with flex additive* (follow the instructions on the can for application and drying time).
7. Wet sand primer with 600 grit sandpaper. Be careful not to sand through the primer. If you do, you **MUST** clean those areas with plastic prep cleaner, apply adhesion promoter and prime. Once the primer has dried, wet sand the areas that were touched up. Your surface is now ready for paint.

* These items can be purchased at any auto body supply store.

Note: Make sure you **PRIME** and **PAINT** the areas where the 2-sided tape is used as you would if it was the finished sided of the part. The tape adheres best when it is applied to a painted surface.



Template For Challenger TA Hood Kit Part #8045

