





# Please Read Carefully

Operate the combination lock immediately several times with the door open to become familiar with it. Don't spin the dial under any circumstances. Always rotate the dial slowly, and make certain you stop the dial exactly on the number called for by the combination. If you pass a number mark, start over from the beginning.

Never use force on the lock. Your combination lock has been carefully tested and inspected. Combination operating problems are rare. If your Mesa Safe opens after difficulty in operating the lock, **DO NOT RELOCK THE SAFE**. Please contact Mesa Safe's Technical Support Team for assistance in correcting the problem [ Ph: 714.202.8000 / Available: Mon - Fri / 7am to 4pm / PST ]. After warranty, we recommend the lock be serviced by a qualified locksmith every two years.

## This is Your Combination.

### To unlock your safe:

-  **Turn LEFT** Stopping when \_\_\_\_\_ comes the Fourth time to mark at top of dial.
-  **Turn RIGHT** Stopping when \_\_\_\_\_ comes the Third time to mark at top of dial.
-  **Turn LEFT** Stopping when \_\_\_\_\_ comes the Second time to mark at top of dial.
-  **Turn full RIGHT** Slowly until dial reaches positive stopping point and open safe.

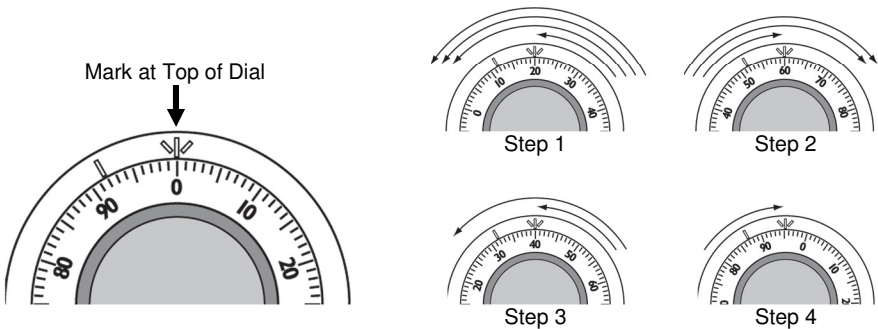

If locking bolt does not retract after you have dialed the combination to open. It is possible the lock was jarred during shipment. Repeat opening procedure using one number **lower** than each number of your combination. Also try one number **higher** than each number. Example: 20-60-40, dial 19-59-39 and 21-61-41. If either sequence of numbers operates your lock, change your instruction sheet accordingly.

### To lock . . .

-  Turn dial to the **LEFT** at least four revolutions. Always make sure your safe is locked and secured.